

SAWMILL ACCESSORY

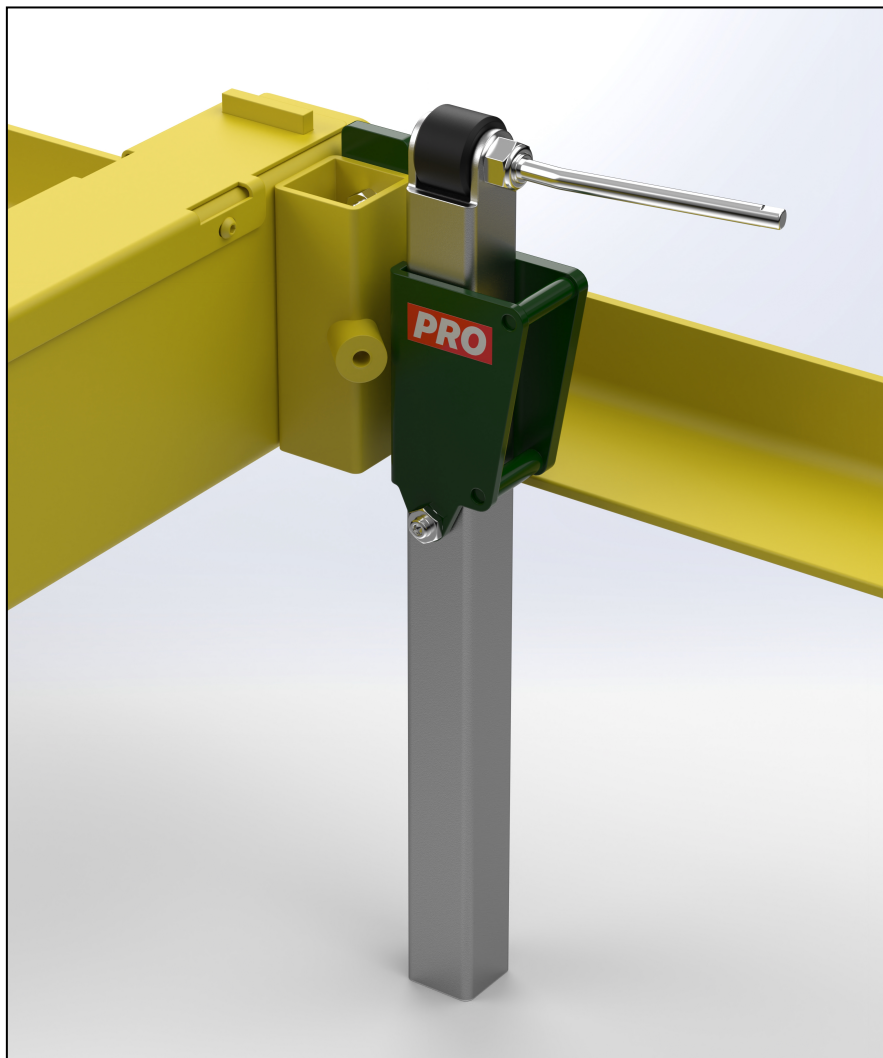

PRO LOG SUPPORT



DISCOVER THE WOODLAND™

GENERAL SAFETY RULES



WARNING!

Remove all log supports and store in a safe location when using a Woodland Mills Sawmill Trailer for travel. Failure to do so could result in loss of parts.

COMPATIBILITY

The PRO Log Support is designed to work with the following sawmill models:

Sawmill Model	PRO Log Support Compatible?
722	No
HM122	Yes
HM126	Yes
HM130	Yes
HM130MAX	Yes

The PRO Log Support is also compatible with the sawmills listed above in combination with any Woodlander™ or Bushlander™ sawmill trailer.



NOTE: BUSHHLANDER SAWMILL OWNERS
See page 6 before proceeding with the
following installation steps.



1. HARDWARE REMOVAL

Remove the hardware from the log support sleeve on the log bunk where the PRO Log Support Holder will be installed.

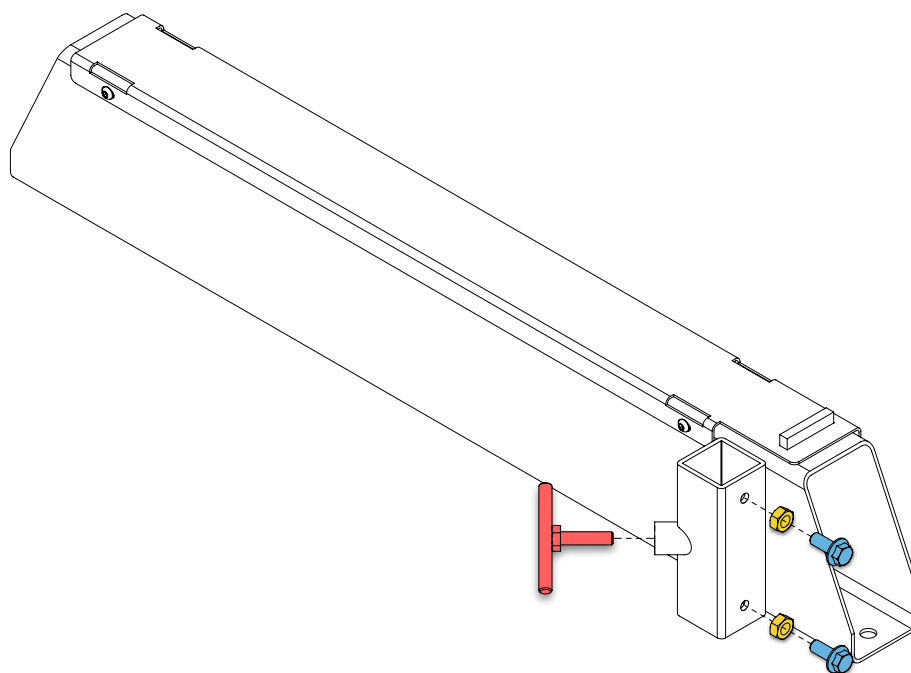

2. LOG SUPPORT HOLDER

Install the PRO Log Support Holder using the hardware listed below.

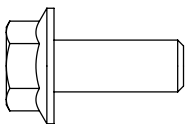
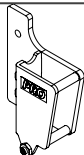
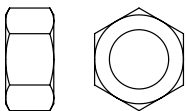
2x	M10 X 25 mm Flanged Hex Bolt		1x	PRO Log Support Holder	
2x	M10 Hex Nut				

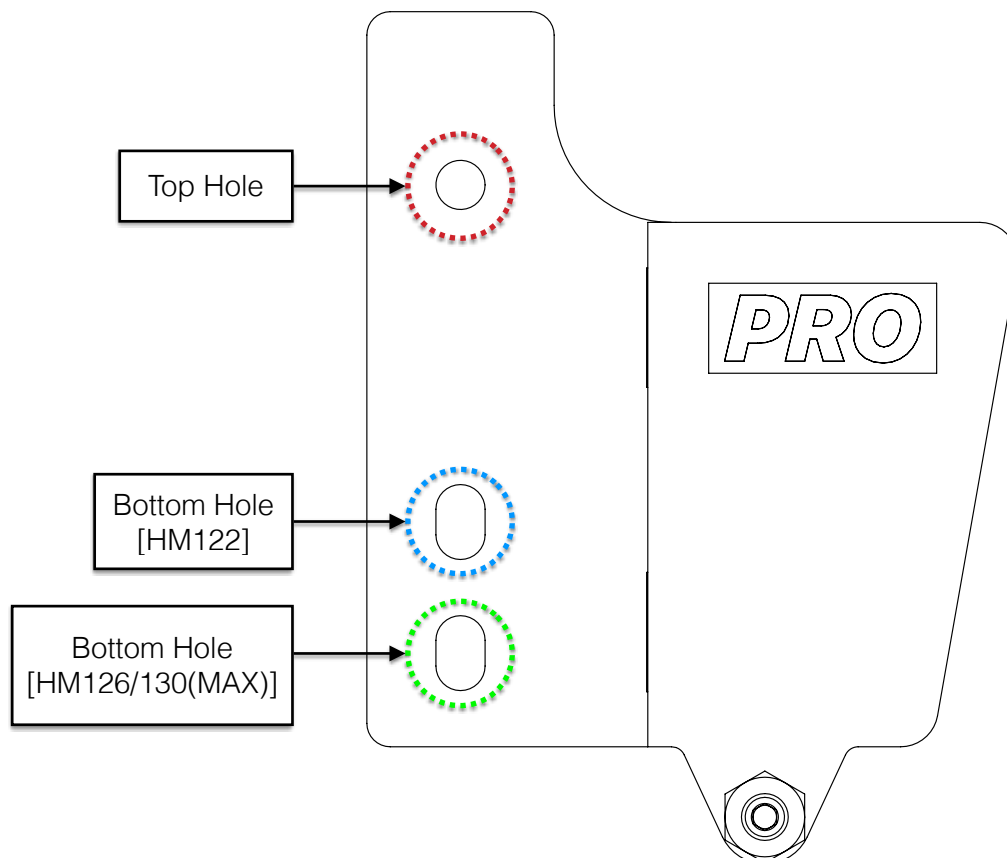
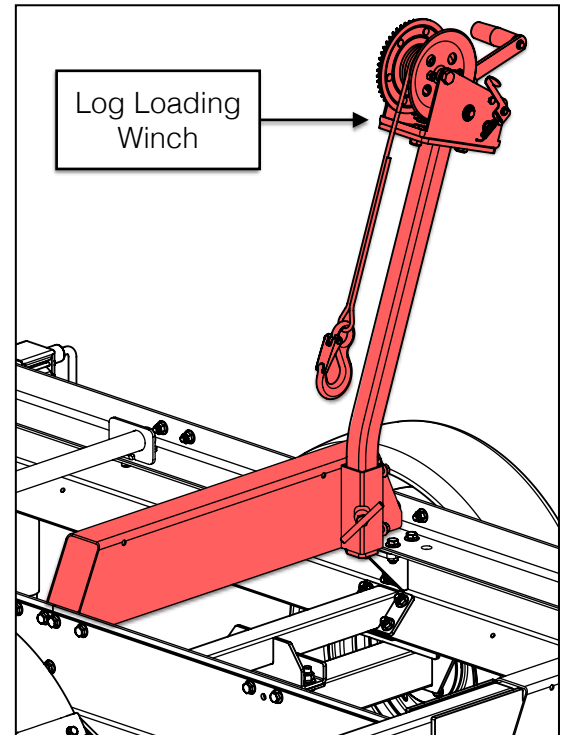
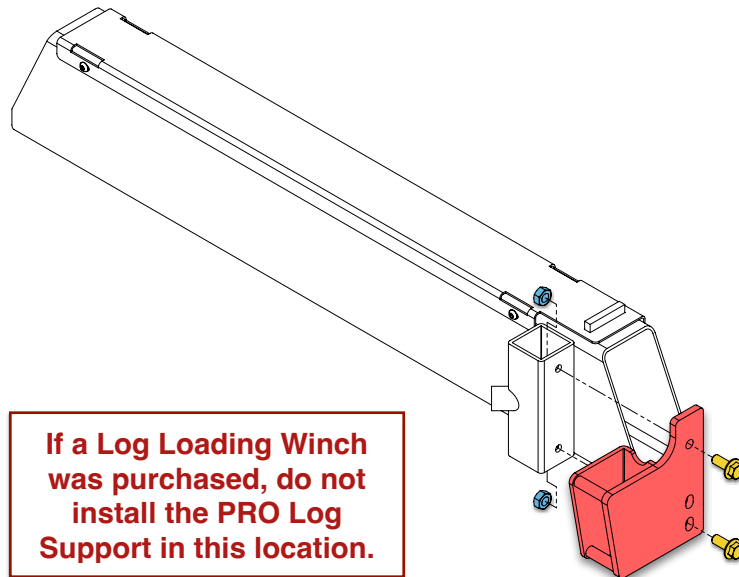

3. LOG SUPPORT

Assemble the PRO Log Support using the hardware listed below.

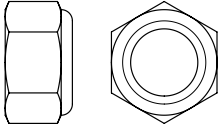
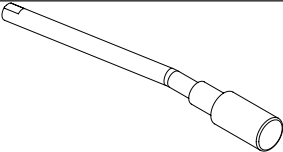
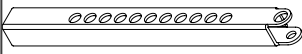
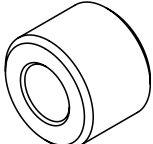
1x	M14 Lock Nut		1x	Log Support Handle	
1x	Log Support Tube		1x	Log Support Roller	

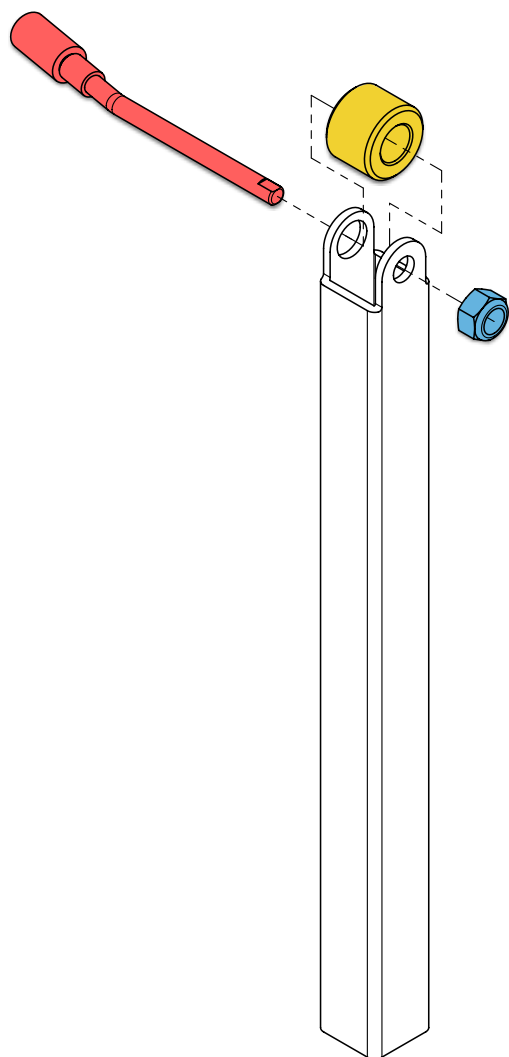

**Ensure the handle faces
away from the log.**

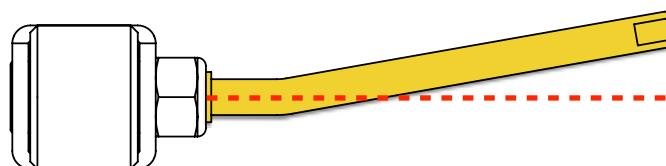

Insert the PRO Log Support into the PRO Log Support Holder. If the PRO Log Support feels too loose in the PRO Log Support Holder, tighten the M10 set screw and thin jam nut.

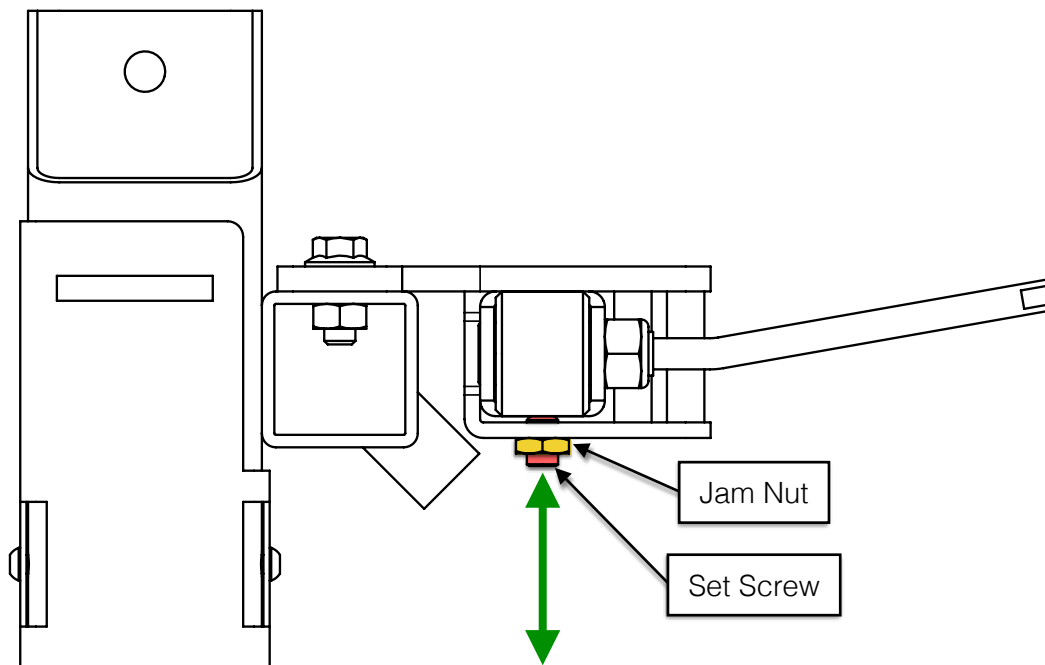

BUSHLANDER SAWMILL ONLY

If the PRO Log Support is being used at the Reverse Bunk location on a Bushlander, the Reverse Bunk will be removed and replaced with the original Log Bunk that came with the sawmill itself.

Remove the Reverse Bunk and reinstall the hardware through the track as shown below.

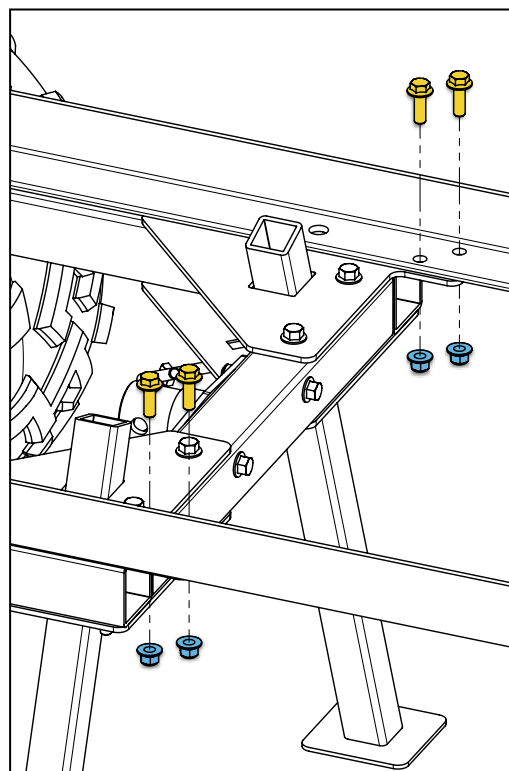
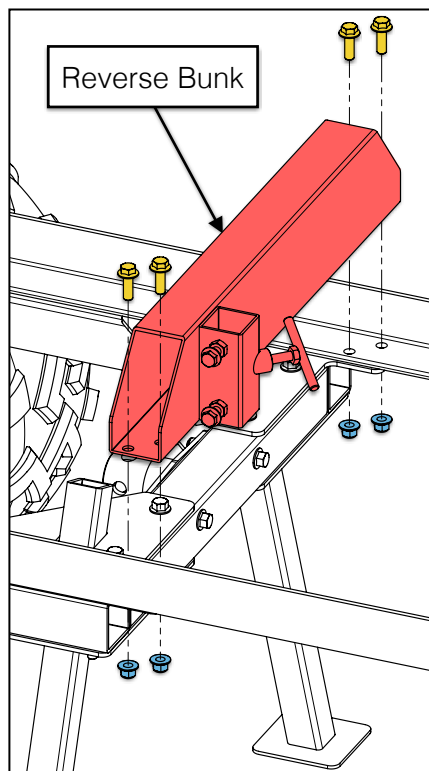
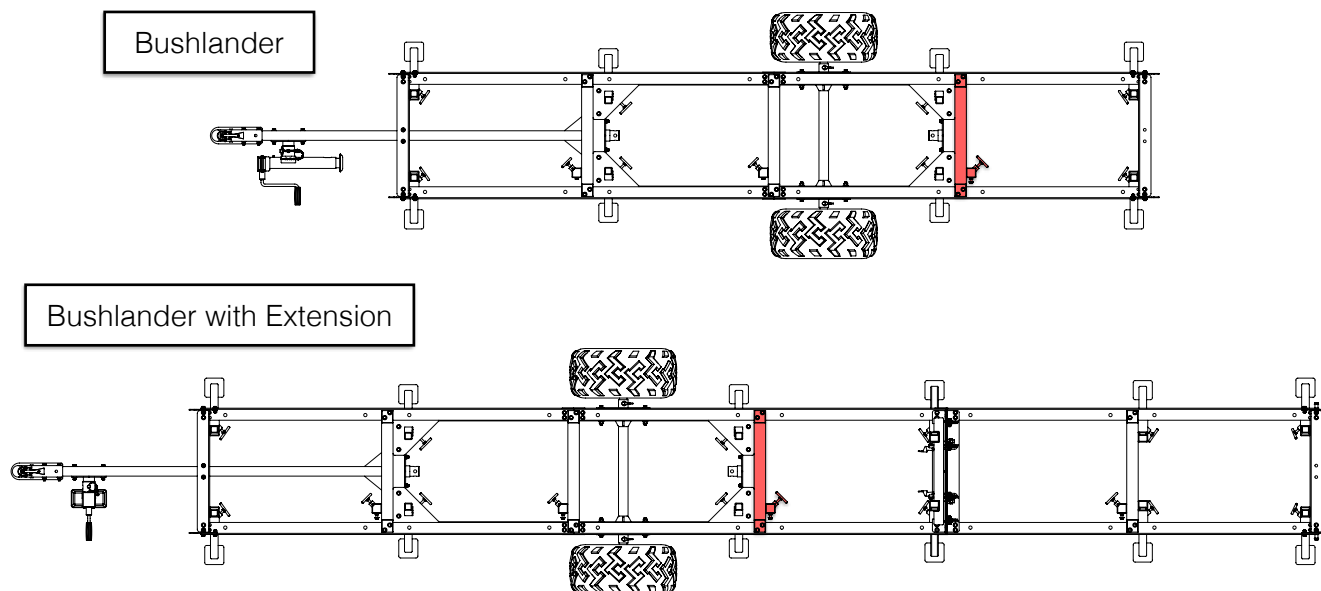

Measure 216 mm (8 ½ in) from the face of the End Beam to the face of the Log Bunk. Using the Log Bunk, mark the locations and drill 12 mm (½ inch) holes through the Track Rail for the new Log Bunk position. Install the Log Bunk in the new position and tighten the hardware.

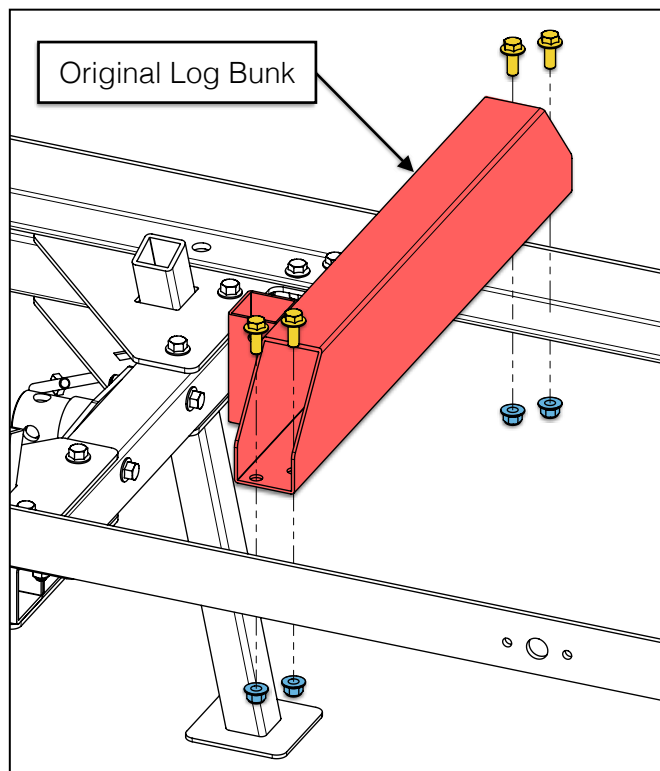
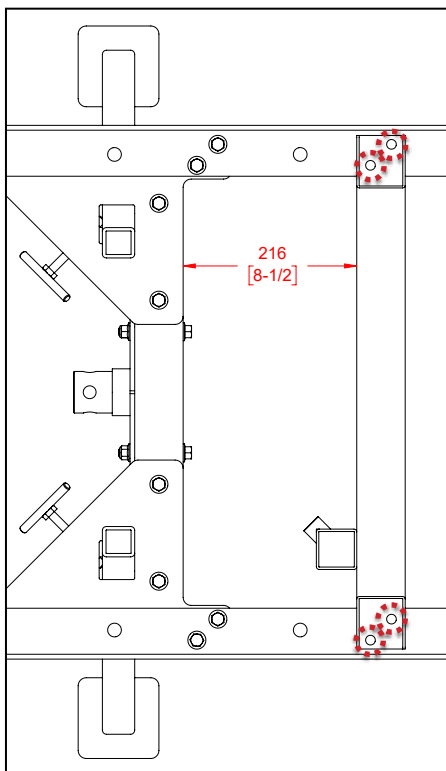

OPERATION

Insert the Log Support Assembly into the Log Support Holder. Ensure the selected Indexing Hole fits securely on the Locking Pin as shown below. The Log Support Assembly can be raised or lowered by angling the Log Support away from the Angled Pin so it can move freely up or down. Secure the log support holder by angling it back toward the Locking Pin and engaging the chosen Indexing Hole.

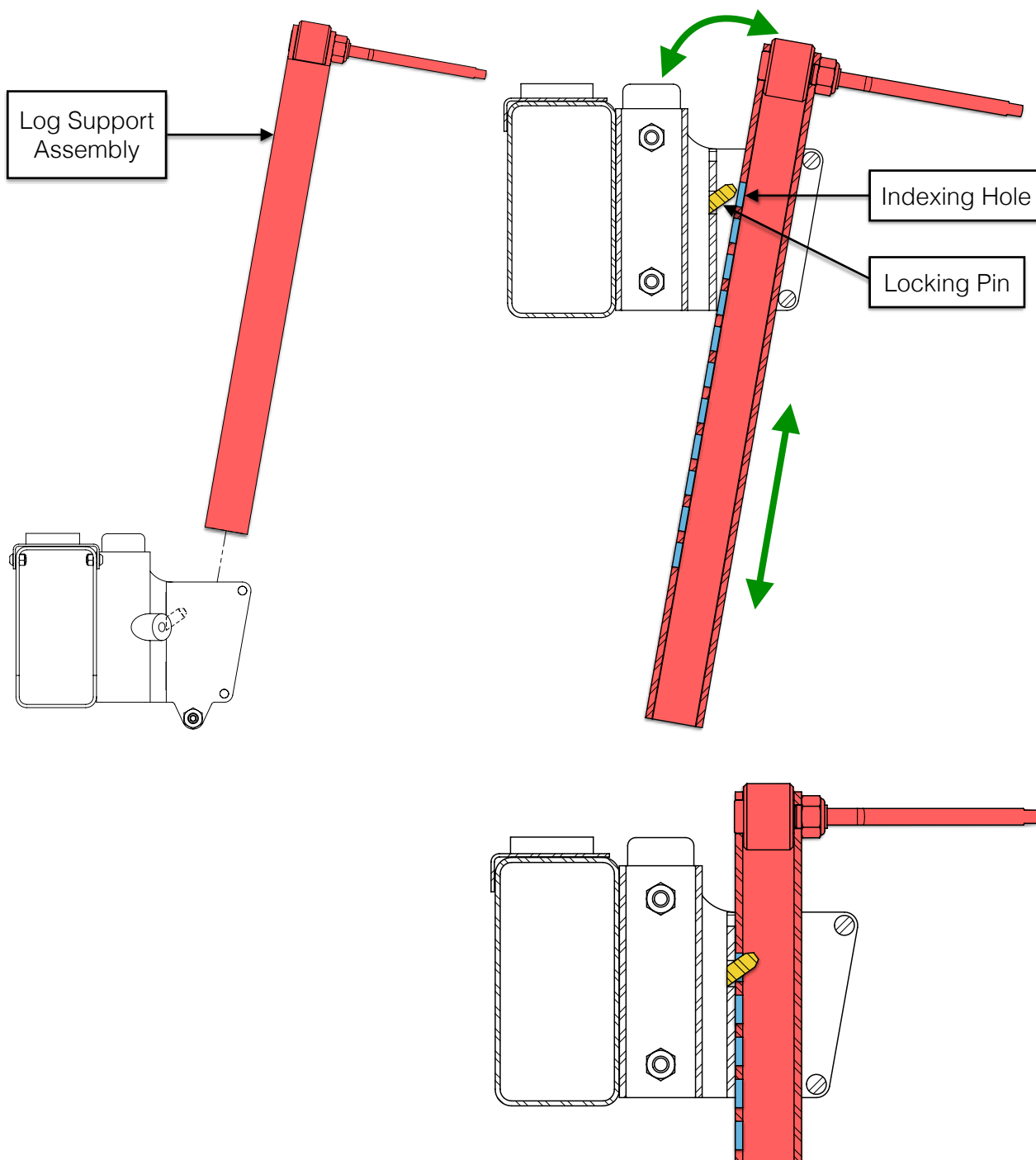

EXPLODED ASSEMBLY VIEW

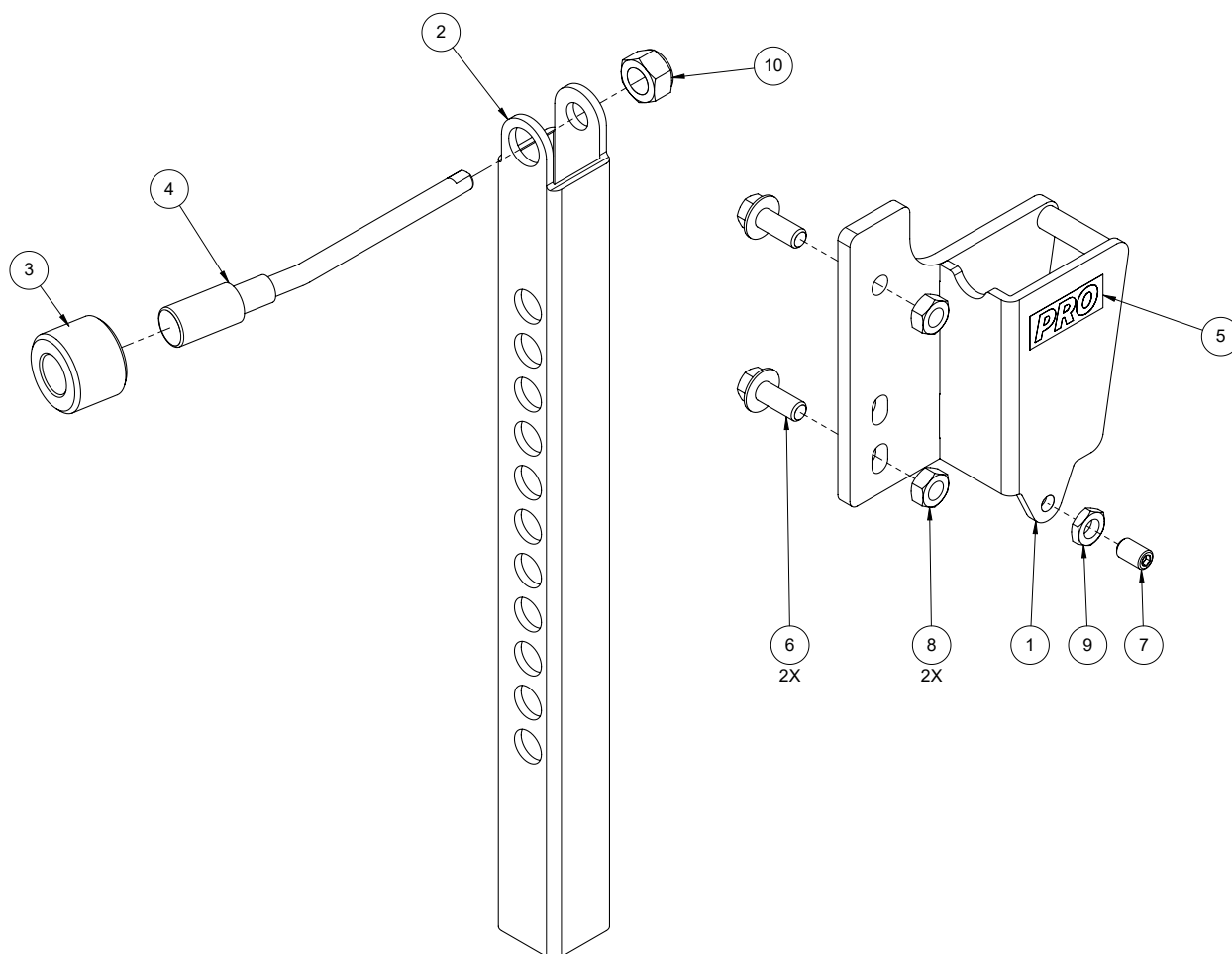

PARTS LIST

Item	Qty	Part No.	Description
1	1	0007342	PRO LOG SUPPORT HOLDER
2	1	0006061	PRO LOG SUPPORT TUBE, 475 mm LG
3	1	0006062	LOG SUPPORT ROLLER, 20.3 ID X 40 OD X 30 mm LG
4	1	0006063	LOG SUPPORT HANDLE
5	1	0009487	PRO LOGO, 19.2 X 48.7 mm
6	2	FHH-MBM080FCJ	HEX BOLT, FLANGED, CLS 8.8, M10 X 1.5, 25 mm LG, FULL
7	1	FTS-MBM071TA	SET SCREW, FLAT TIP, SST, M10 X 1.5, 16 mm LG
8	2	HXN-MBMCH	HEX NUT, CLS 8, M10 X 1.5
9	1	THN-MBMCC	HEX NUT, THIN, CLS 4, M10 X 1.5
10	1	HLN-MBWCH	LOCK NUT, CLS 8, M14 X 2

[illegible]

This image shows a single sheet of white paper with horizontal blue ruling lines. The lines are evenly spaced and run across the width of the page. There are no margins, text, or other markings on the paper.

[illegible]



DISCOVER THE WOODLAND™