

WC46 STORAGE STATE: OVERALL DIMENSIONS

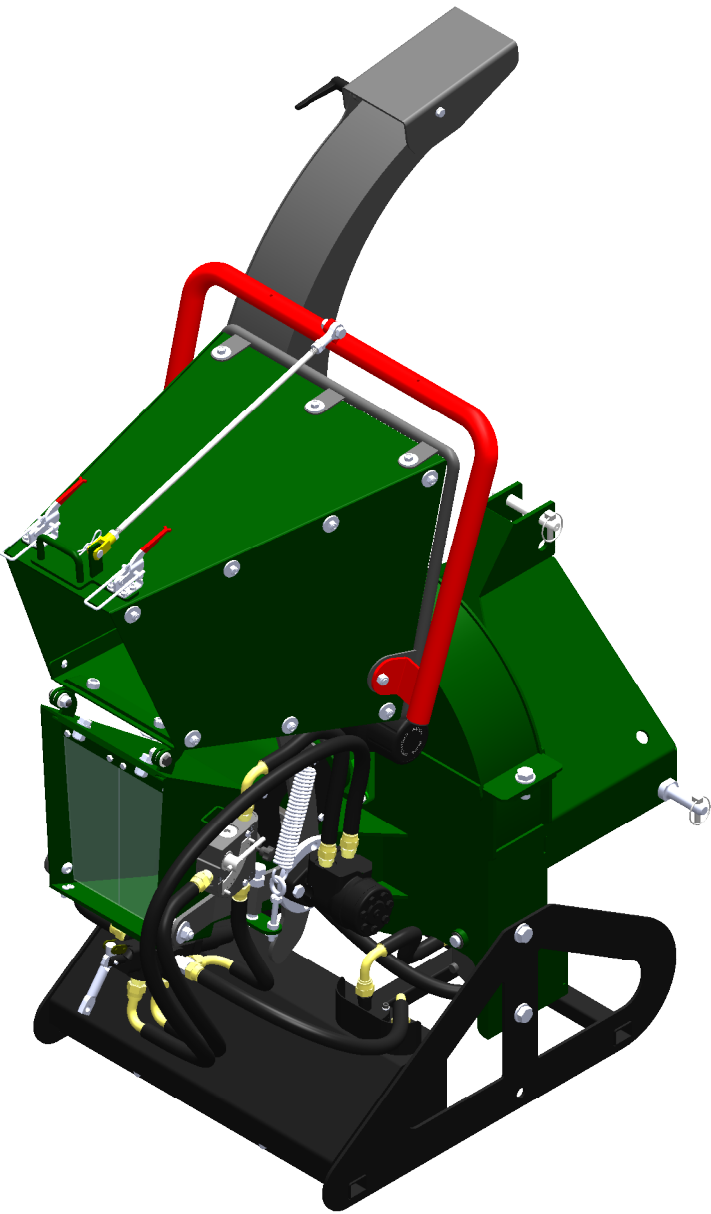
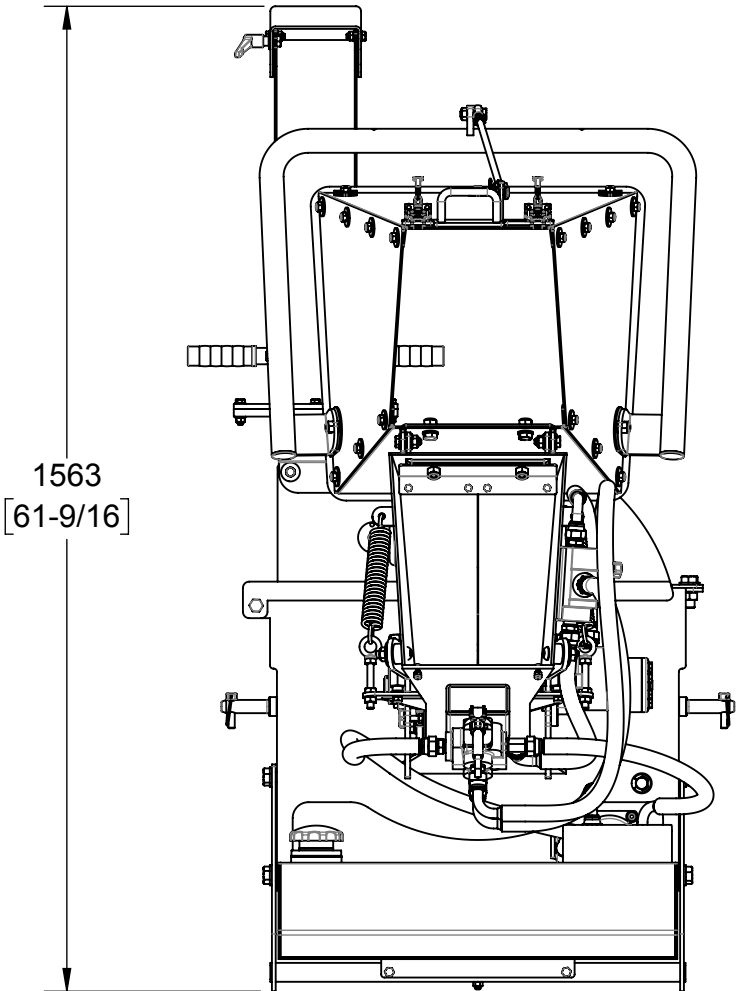
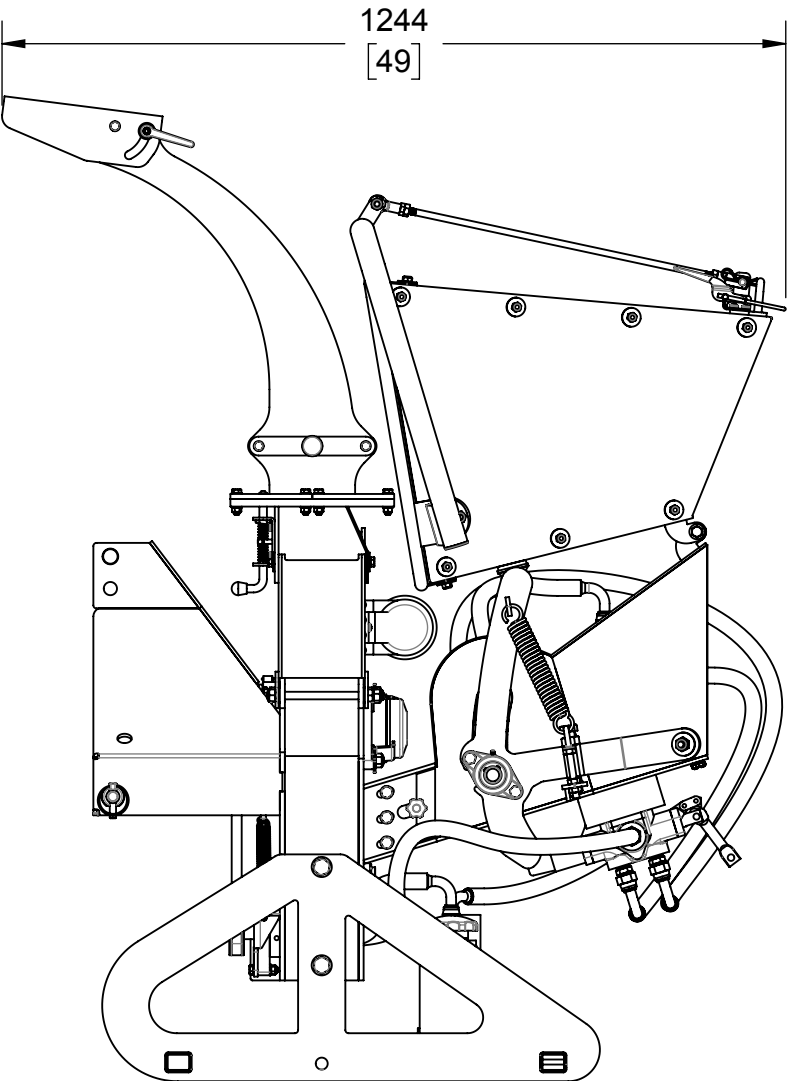
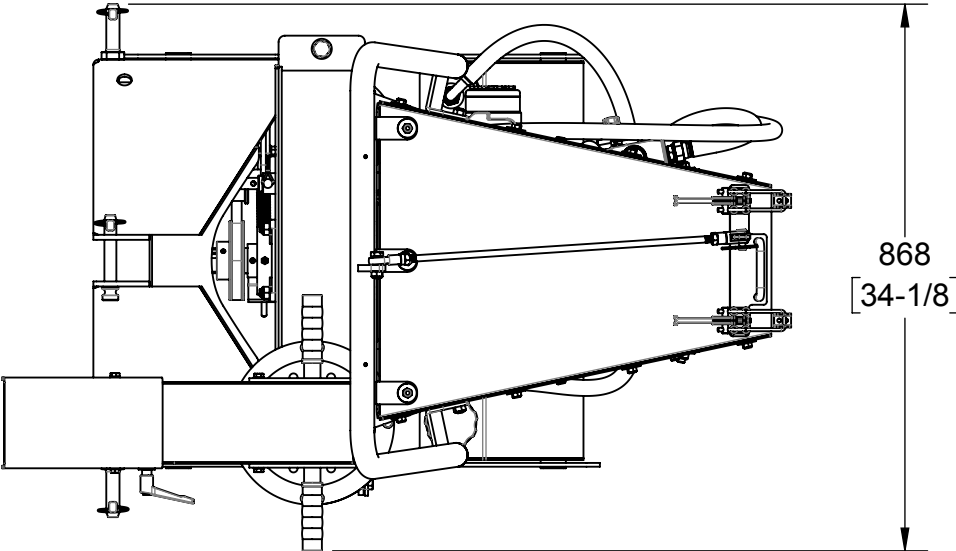

- NOTES:
1. DIMENSIONS LOCATED WITHIN SQUARE BRACKETS [ ] ARE IN INCHES.

		WOODLAND MILLS FORESTRY EQUIPMENT 171 NORTH PORT RD, UNIT #1 PORT PERRY, ON L9L 1B2, CANADA 1 (855) 476-6455		
SIZE <b>A3</b>	DWG NO	<b>0001710</b>		REV
SCALE 1:12	DATE 08-08-2018	SHEET 2 OF 3		

WC46: 3-POINT HITCH DIMENSIONS

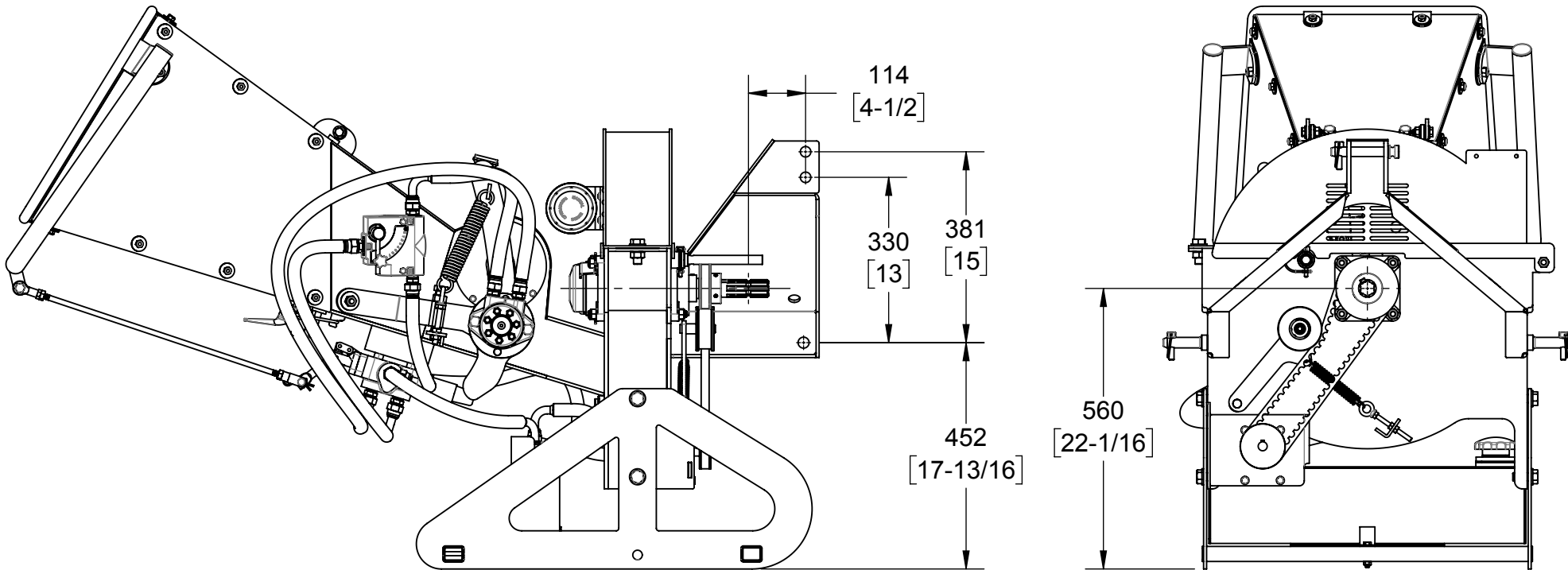
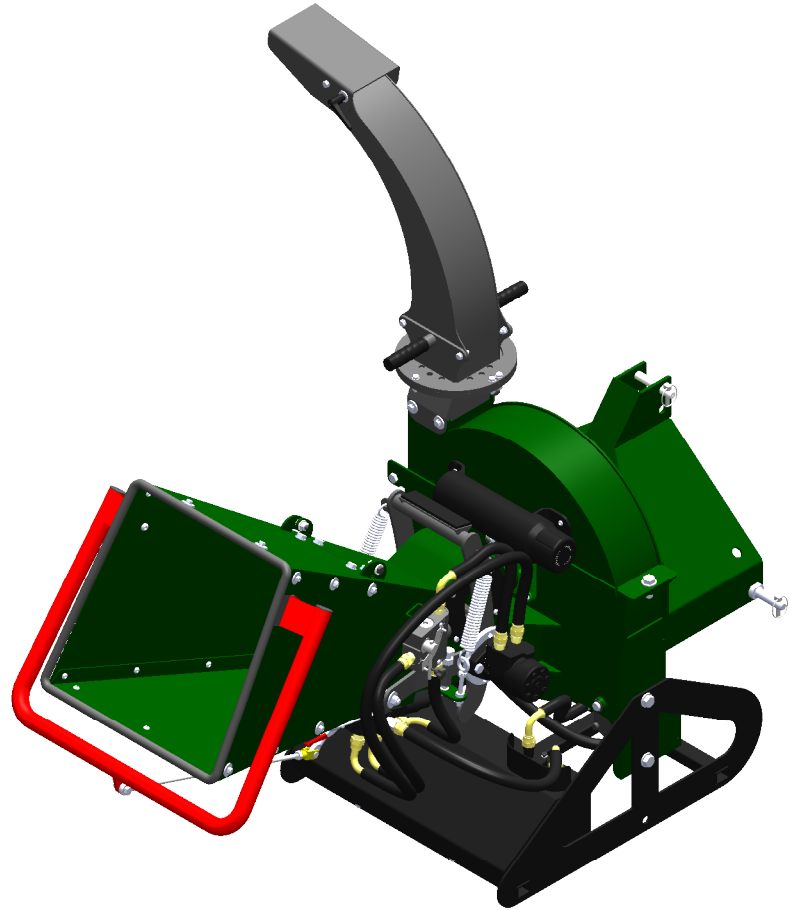
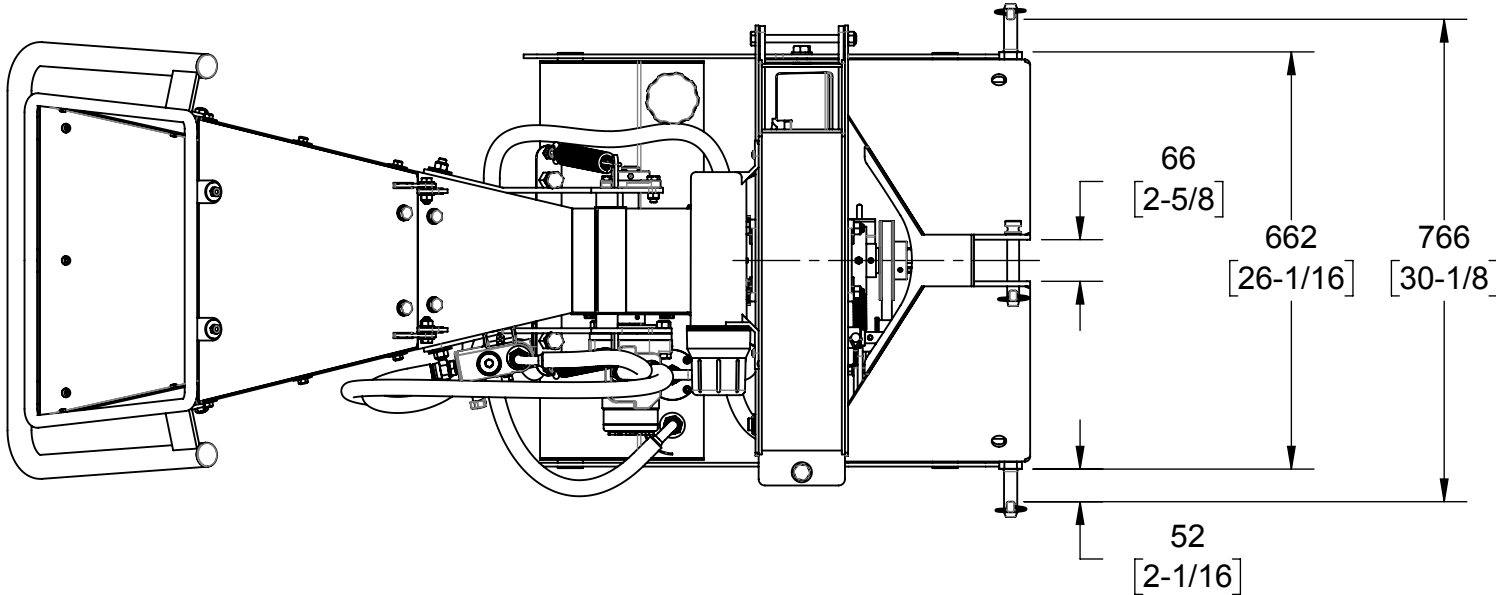

NOTES:

1. DIMENSIONS LOCATED WITHIN SQUARE BRACKETS [ ] ARE IN INCHES.
2. DISCHARGE CHUTE REMOVED FROM SOME VIEWS FOR CLARITY.

		WOODLAND MILLS FORESTRY EQUIPMENT 171 NORTH PORT RD, UNIT #1 PORT PERRY, ON L9L 1B2, CANADA 1 (855) 476-6455		
SIZE <b>A3</b>	DWG NO	<b>0001710</b>		REV
SCALE 1:12	DATE 08-08-2018	SHEET 3 OF 3		

# WC46 OPERATING STATE: OVERALL DIMENSIONS

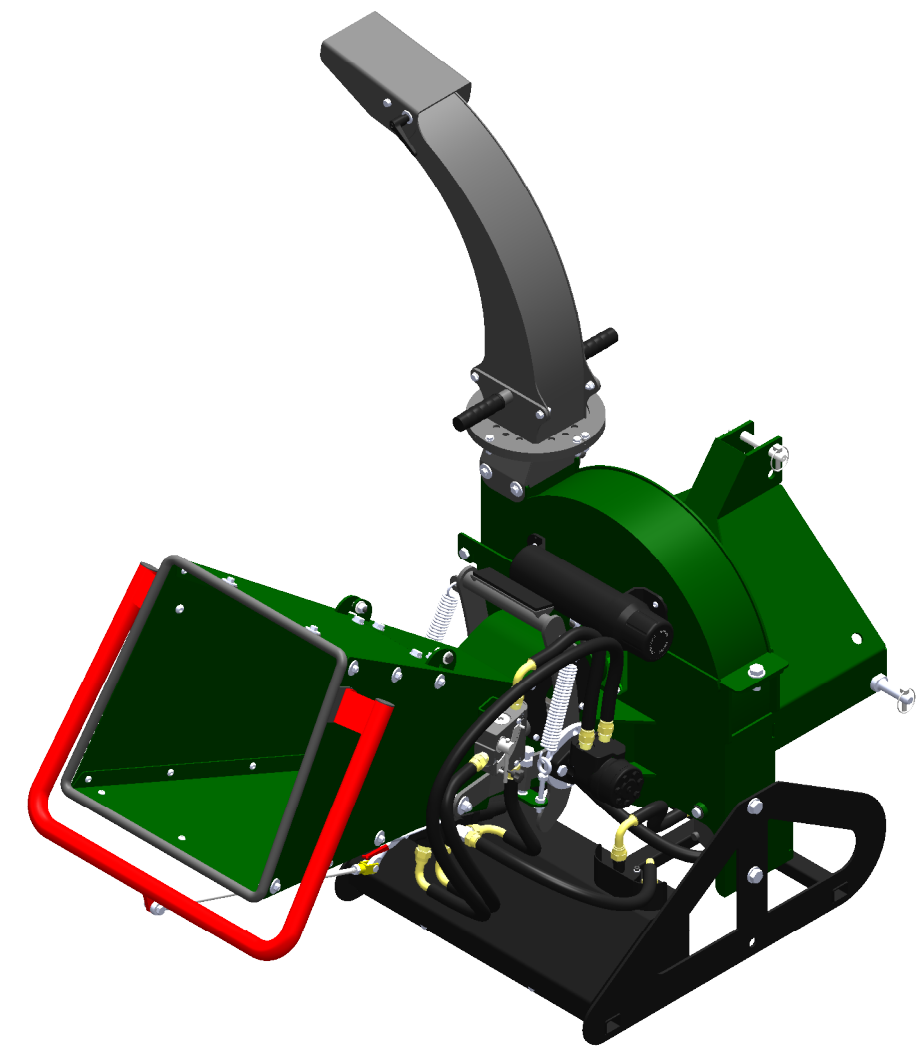
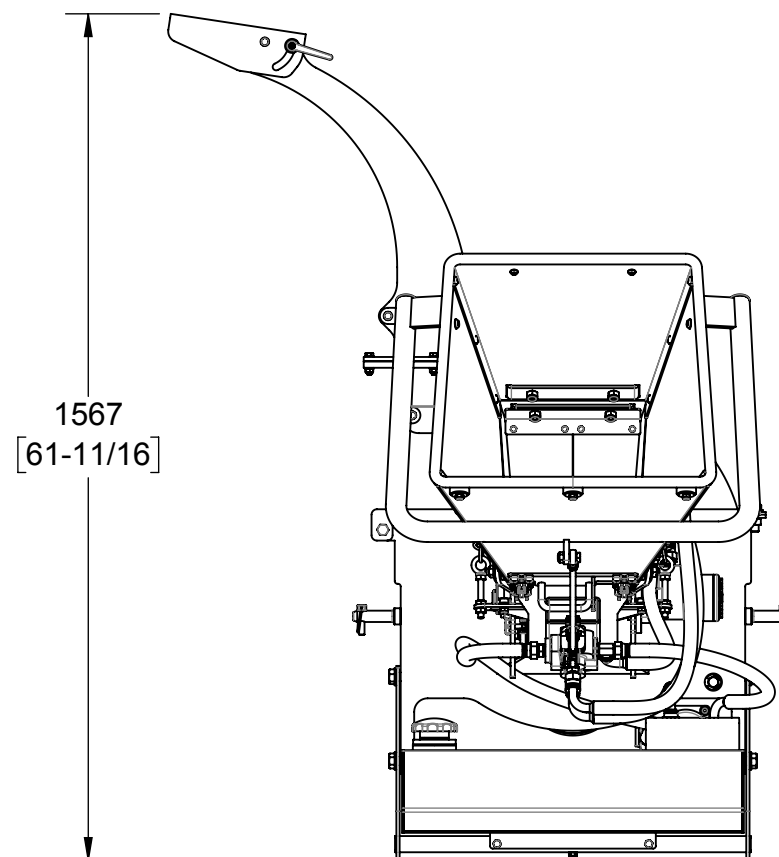
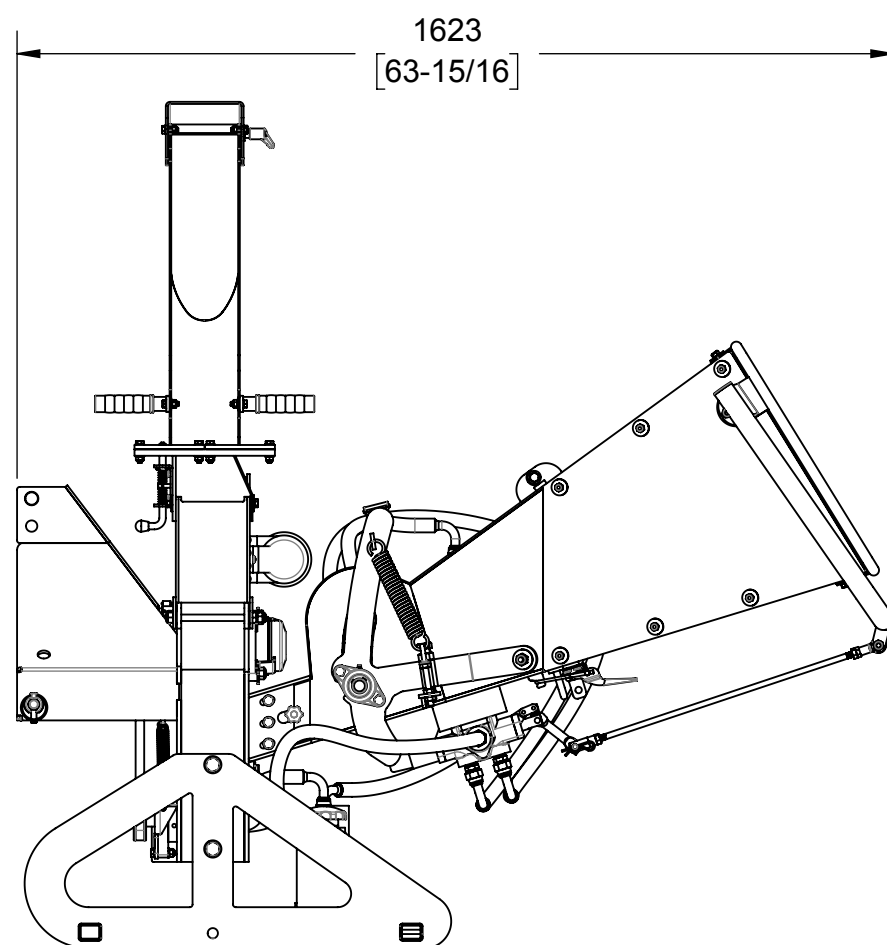
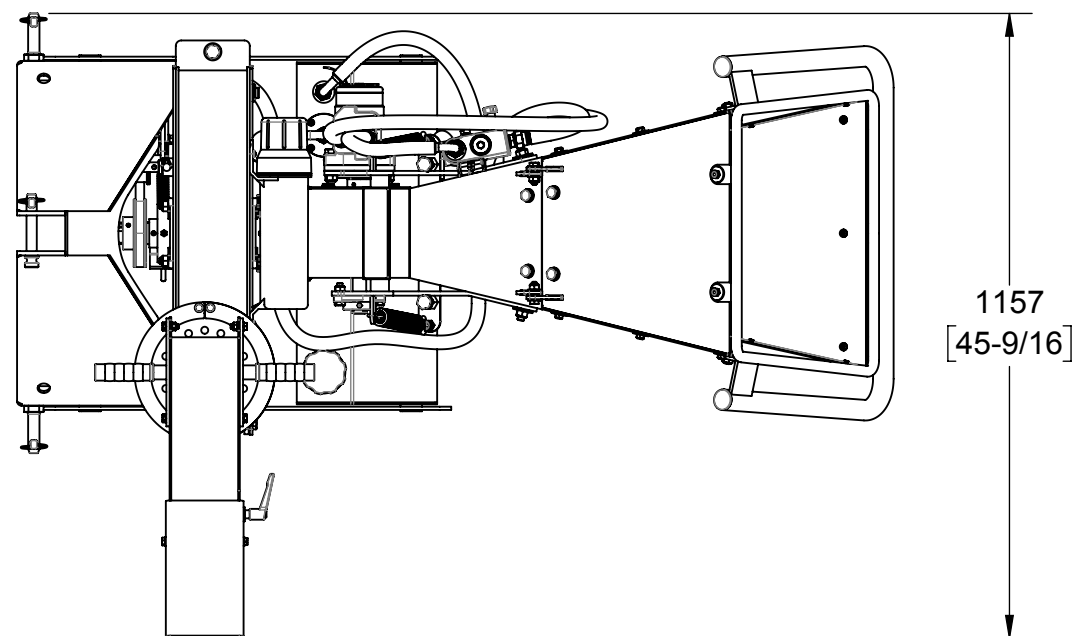

## NOTES:

1. DIMENSIONS LOCATED WITHIN SQUARE BRACKETS [ ] ARE IN INCHES.

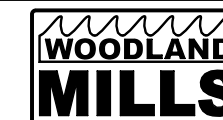

WOODLAND MILLS FORESTRY EQUIPMENT  
171 NORTH PORT RD, UNIT #1  
PORT PERRY, ON L9L 1B2, CANADA  
1 (855) 476-6455

SIZE <b>A3</b>	DWG NO <b>0001710</b>	REV
SCALE 1:14	DATE 08-08-2018	SHEET 1 OF 3